



2000 I-30 E - Greenville, TX 75402
(903) 455-1715

Thursday, October 8, 2020

Office of Hopkins County Judge
PO Box 288
Sulphur Springs TX 75483

Farmers Electric Cooperative Member: DARRELL DODD
Service Order Number: 2020093434

Greetings:

Farmers Electric Cooperative, Inc. is requesting permission to construct electrical power distribution facilities which will cross County Road 2324 which is located 580 ft. east of CR 2327 in Hopkins County, Texas.

Site location map and construction sketches are enclosed. The construction sketch details the proposed work. All road crossings will have a minimum vertical clearance of 22 feet.

If you have any questions, please contact me at any time.

Sincerely,

Tamara Williams
Project Coordinator
twilliams@farmerelectric.coop
Phone 903-513-2903

Submitted by Brandon Darrow
bdarrow@farmerelectric.coop
Field Engineering Coordinator

Enclosures

County Approval Section:

Approved: ✓ Denied: _____

Authorized Signature: *[Signature]*

Date: 10-13-20

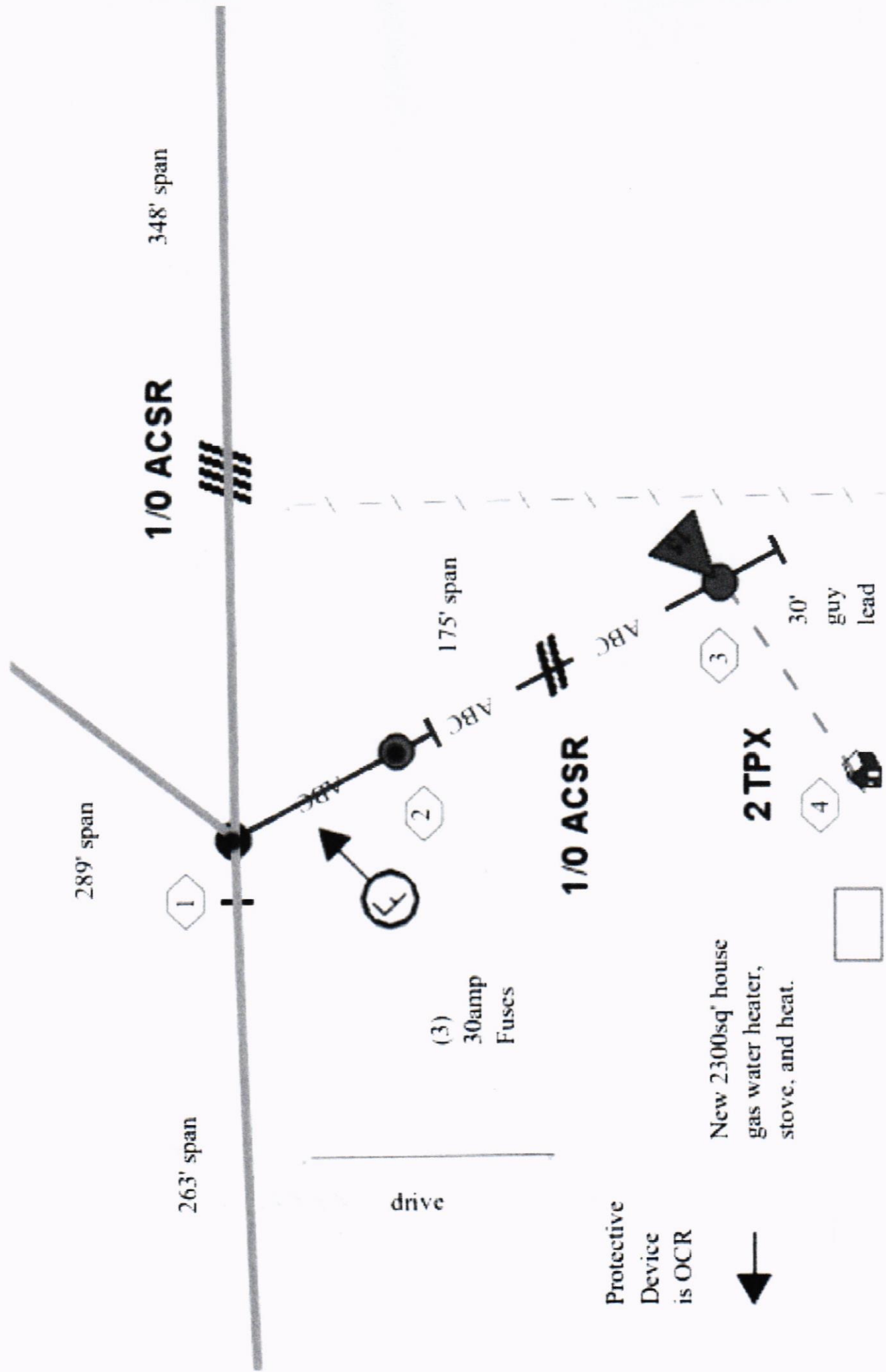

Protective Device is OCR



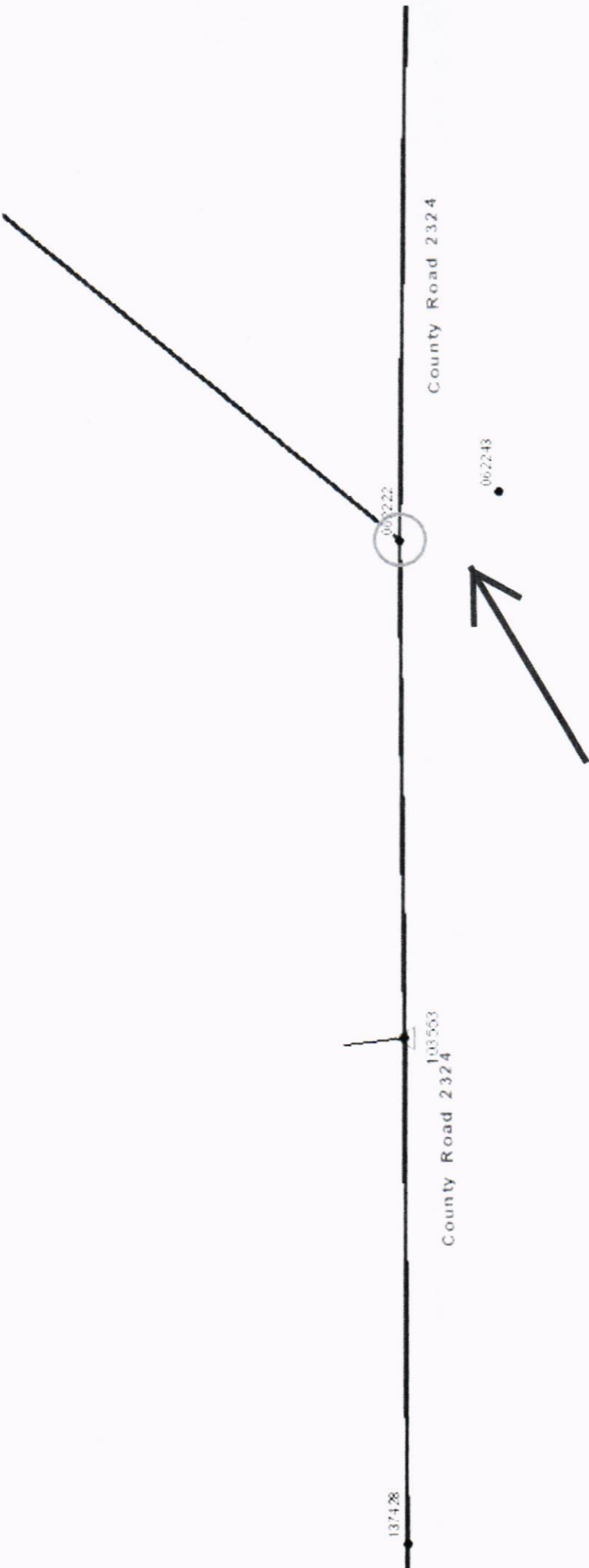

Darrell Dodd
Service Order#
2020093434
Cross CR 2324 to
existing pole#062243.